

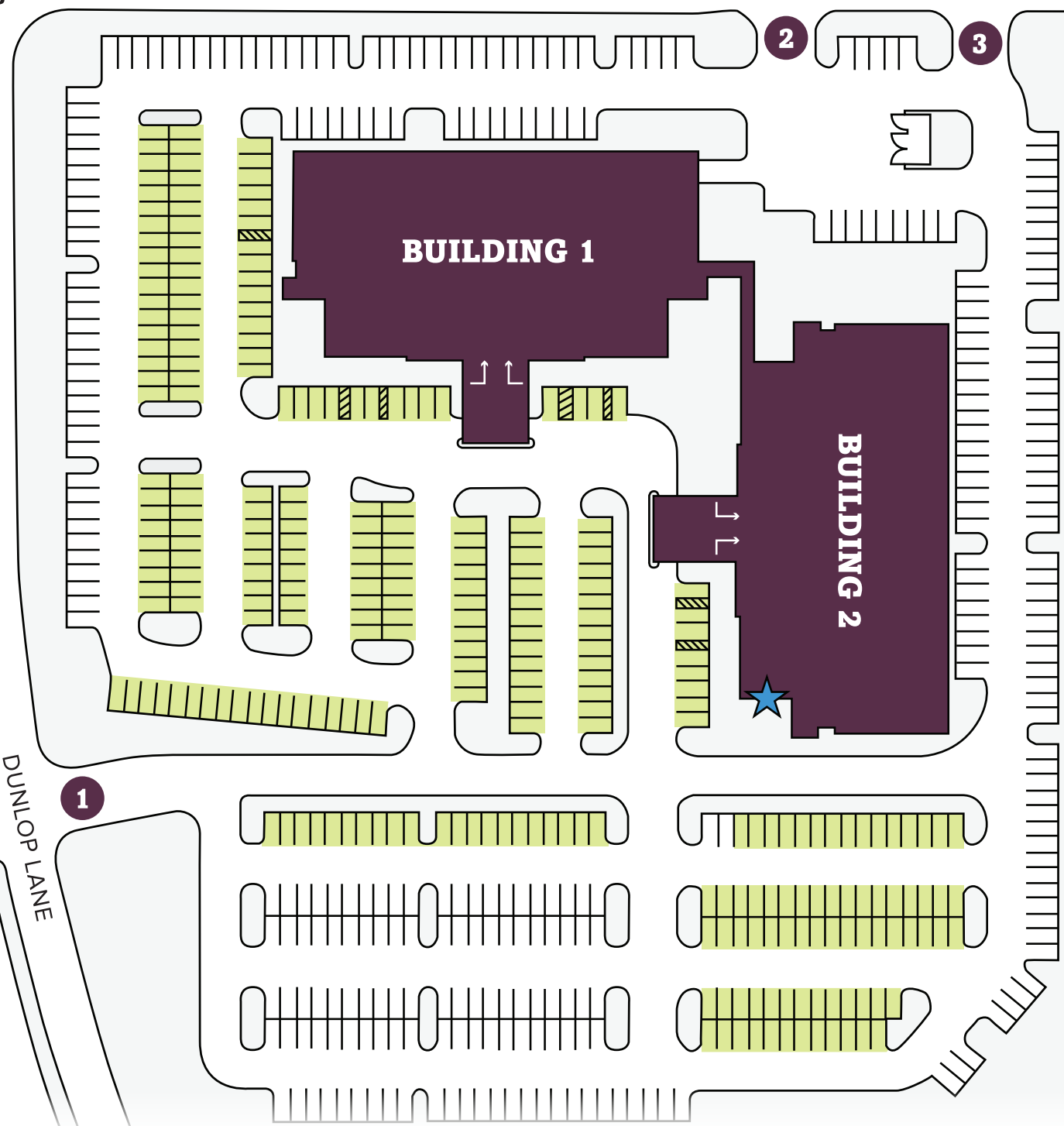

CHESAPEAKE LANE



Premier
MEDICAL GROUP

BUILDING 1

First Floor:
Family Medicine Walk-In Clinic
Occupational & Travel Medicine
Lab and Imaging

Second Floor:
Family Medicine
Internal Medicine

BUILDING 2

First Floor:
Pediatrics
Pediatrics Walk-In Clinic

Second Floor:
Obstetrics & Gynecology
Administration
Business Office
Scheduling

 **Pediatrics Clinic Entrance**
for after 5 pm and weekends.

 **Campus Entrances/Exits**
We suggest using exits 2 or 3
to turn West on Dunlop Lane.

 **Patient Parking**